

'Static Head' Storage Tank
110% Contained ULC-S601-14
1,250 ltr to 25,000 ltr

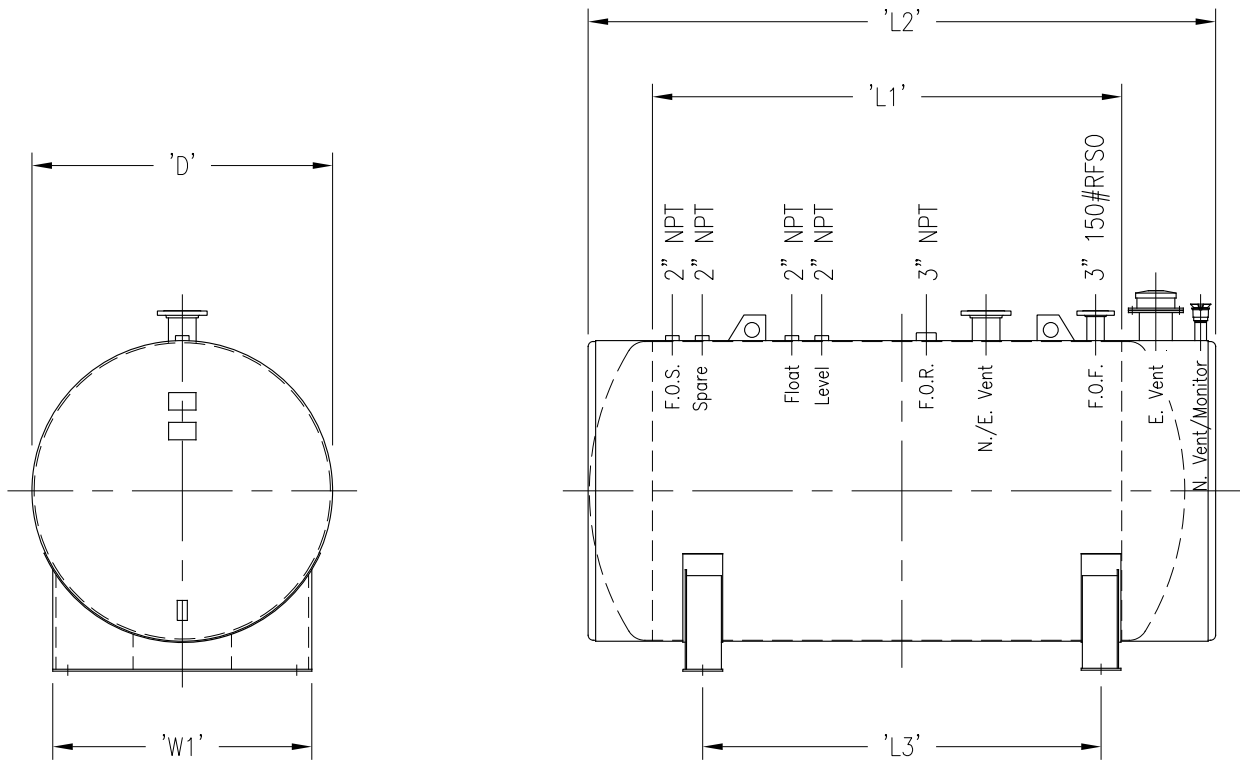

Part I.D.	Capacity		Diameter 'D' mm [in]	Length 'L1' mm [in]	'L2' mm [in]	'L3' mm [in]	'W1' mm [in]	Weight Kg [lb]
	Litre	I.G.						
SCSHDFT01250	1,250	275	915 [36]	1,702 [67]	2,235 [88]	1,295 [51]	838 [33]	618 [1,359]
SCSHDFT02440	2,440	537	1,220 [48]	1,804 [71]	2,464 [97]	1,422 [56]	1,117 [44]	900 [1,980]
SCSHDFT05000	5,000	1,100	1,524 [60]	2,388 [94]	3,200 [126]	2,032 [80]	1,372 [54]	1,421 [3,128]
SCSHDFT10000	10,000	2,200	1,980 [78]	2,820 [111]	3,734 [147]	2,337 [92]	1,778 [70]	2,488 [5,474]
SCSHDFT15000	15,000	3,300	1,980 [78]	4,572 [180]	5,512 [217]	3,556 [140]	1,778 [70]	3,235 [7,117]
SCSHDFT25000	25,000	5,500	1,980 [78]	7,772 [306]	8,966 [353]	7,214 [284]	1,778 [70]	4,690 [10,318]

NOTES:

- BUILT & LABELLED TO ULC-S601-14 (110% integral contained)
- MATERIAL OF CONSTRUCTION: CARBON STEEL
- EXTERIOR FINISH: BLAST TO SSPC-SP6, ONE COAT PRIMER & ONE FINISH COAT WHITE ENAMEL
- EACH TANK SUPPLIED WITH DIPSTICK, GAUGE CHART & TOUCH-UP PAINT
- OPTIONAL STAIRWAY & PLATFORM ASS'Y CAN BE INSTALLED IN THREE DIFFERENT POSITIONS.

- rated normal vent: up to 15000 ltr = 2", over 15000 ltr = 3"
- rated emergency vent: up to 25000 ltr = 6"

STEELCRAFT
 Engineered Products Division

DESCRIPTION: Horizontal A/G 110% Contained 'Static Head' Tank

CUSTOMER:

PROJECT:

ITEM NO.: see chart

DRN.: HK 8-FEB-17

SCALE: NTS

JOB NO.:

DWG. NO.: S601-110SH

2