

STEELCRAFT P/N: SCDHWT66X132

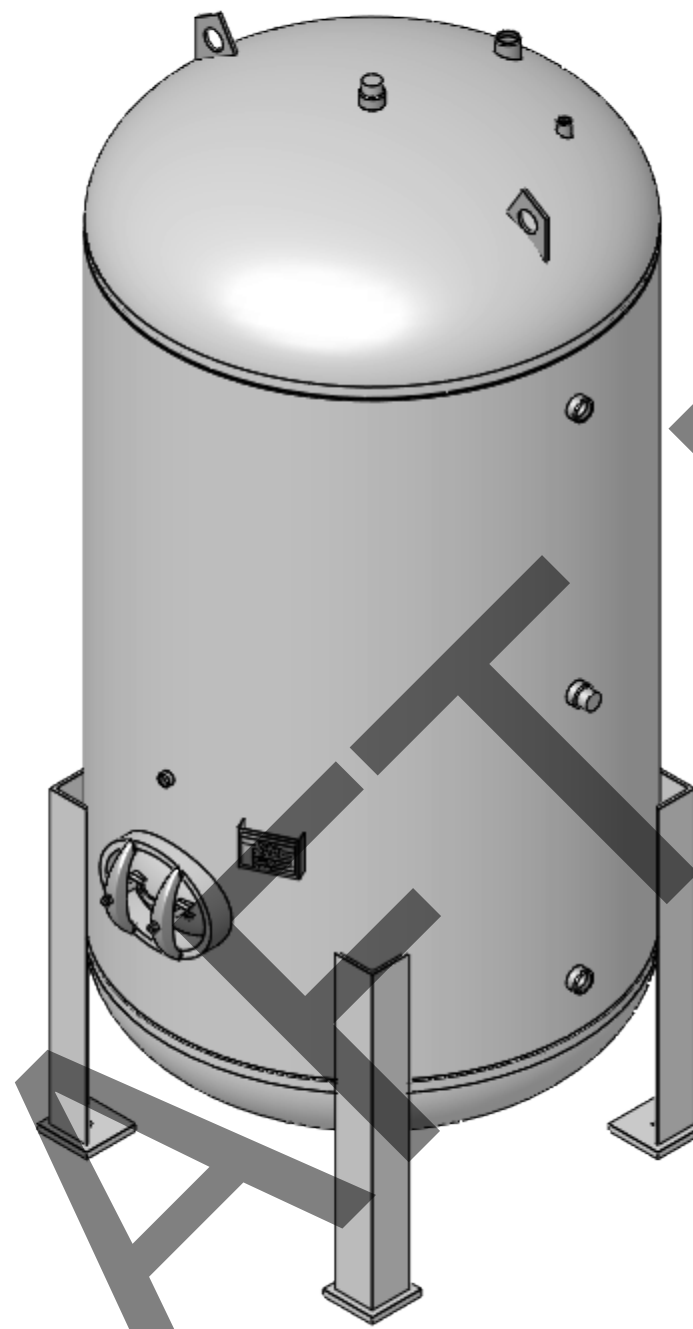
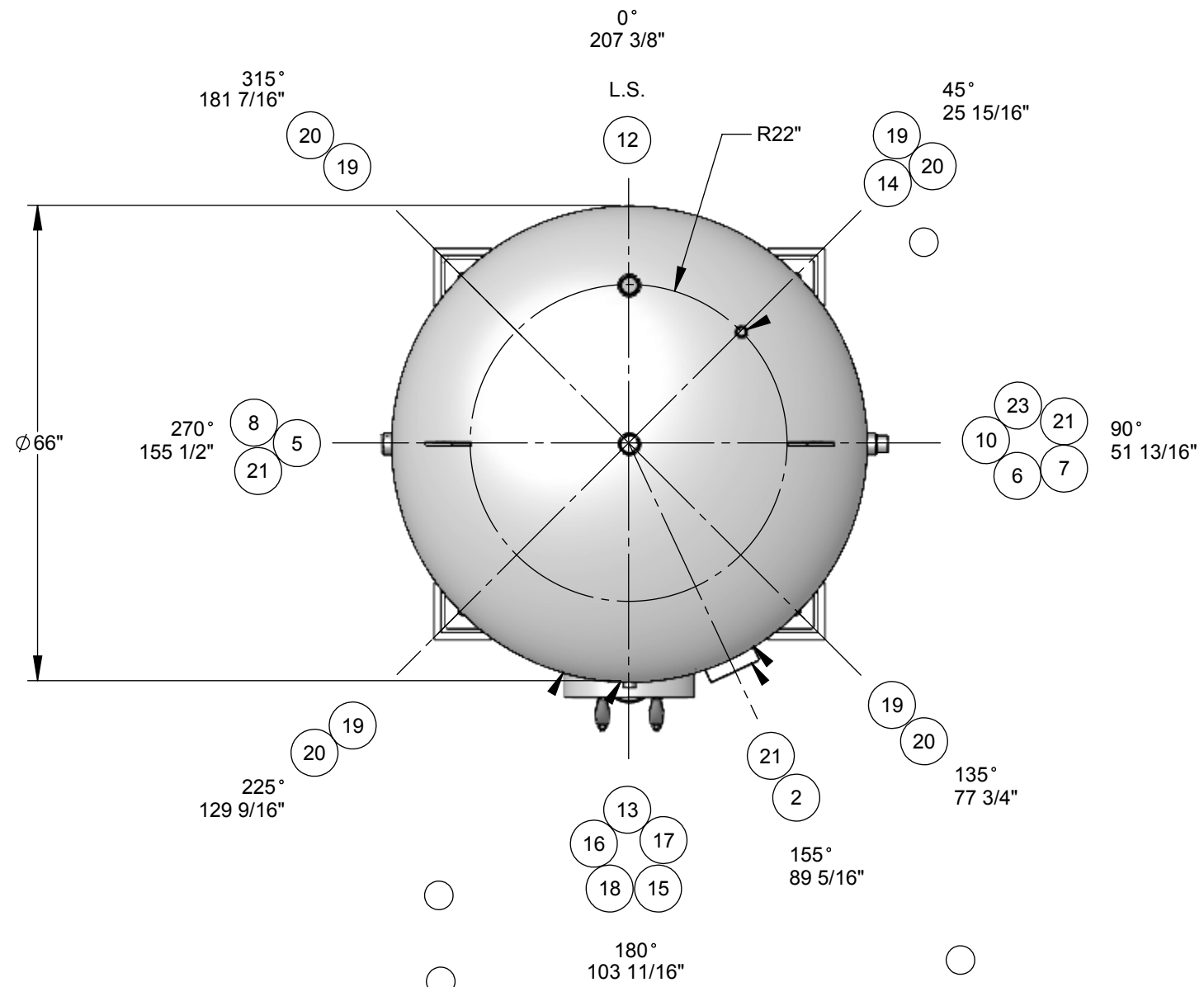

ITEM NO.	QTY.	PART NO.	DESCRIPTION
1	1	A43979-01	Cylinder: 66" O.D. x 97" Lg.
2	1	A43974 - NP	ASME NAMEPLATE
3	1	HDSE066001FJ	Head: S.E., 66" O.D.
4	1	HDSE066001FJ	Head: S.E., 66" O.D.
5	1	CPHT200300XU	Coupling: 2" NPT
6	1	CPHT200300XU	Coupling: 2" NPT
7	1	CPHT200300XU	Coupling: 2" NPT
8	1	CPHT200300XU	Coupling: 2" NPT
9	1	CPHT200300XU	Coupling: 2" NPT
10	1	CPHT200300XU	Coupling: 2" NPT
11	1	CPHT200300XU	Coupling: 2" NPT
12	1	CPFT200300XU	Coupling: 2" NPT
13	1	CPHT100300XU	Coupling: 1" NPT
14	1	CPFT100300XU	Coupling: 1" NPT
15	1	MHCO121640UC	Manway Collar: 12" x 16" x 1" x 4" Wide
16	1	GSKO121600XY	Manway Gasket
17	1	CVRB121615XC	Manway Cover
18	2		Manway Yoke c/w Bolt & Nut
19	4	A43974-L	6" X 6" X 47" LG ANGLE
20	4	A43974-FP	8" X 8" X 1" Thk. FOOT PAD WITH 1-1/4" HOLE
21	1	BKPL400055XC	Nameplate Bracket
21	2	LLTV050075QC	Lift Lug
23	2	ANDA200220XM	Anode, 2" Screwed Magnesium

Design Specifications

M.A.W.P.: 150 psi
 Design Temperature: 500 °F
 M.D.M.T.: 0°F @ 150 psi
 Impact Testing Exempt per UG-20(f) & UCS-66
 Design External Pressure: 0.0 psi
 Hydrotest Pressure: 195 psi
 Corrosion Allowance: 0.0 in.
 Code: ASME Section VIII, Div. 1 2017
 Approximate Volume: 6369 L
 Approximate Weight: 4656 lbs
 Material of Construction: Carbon Steel

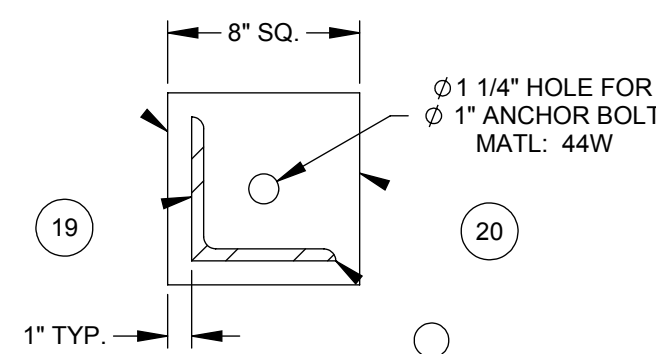
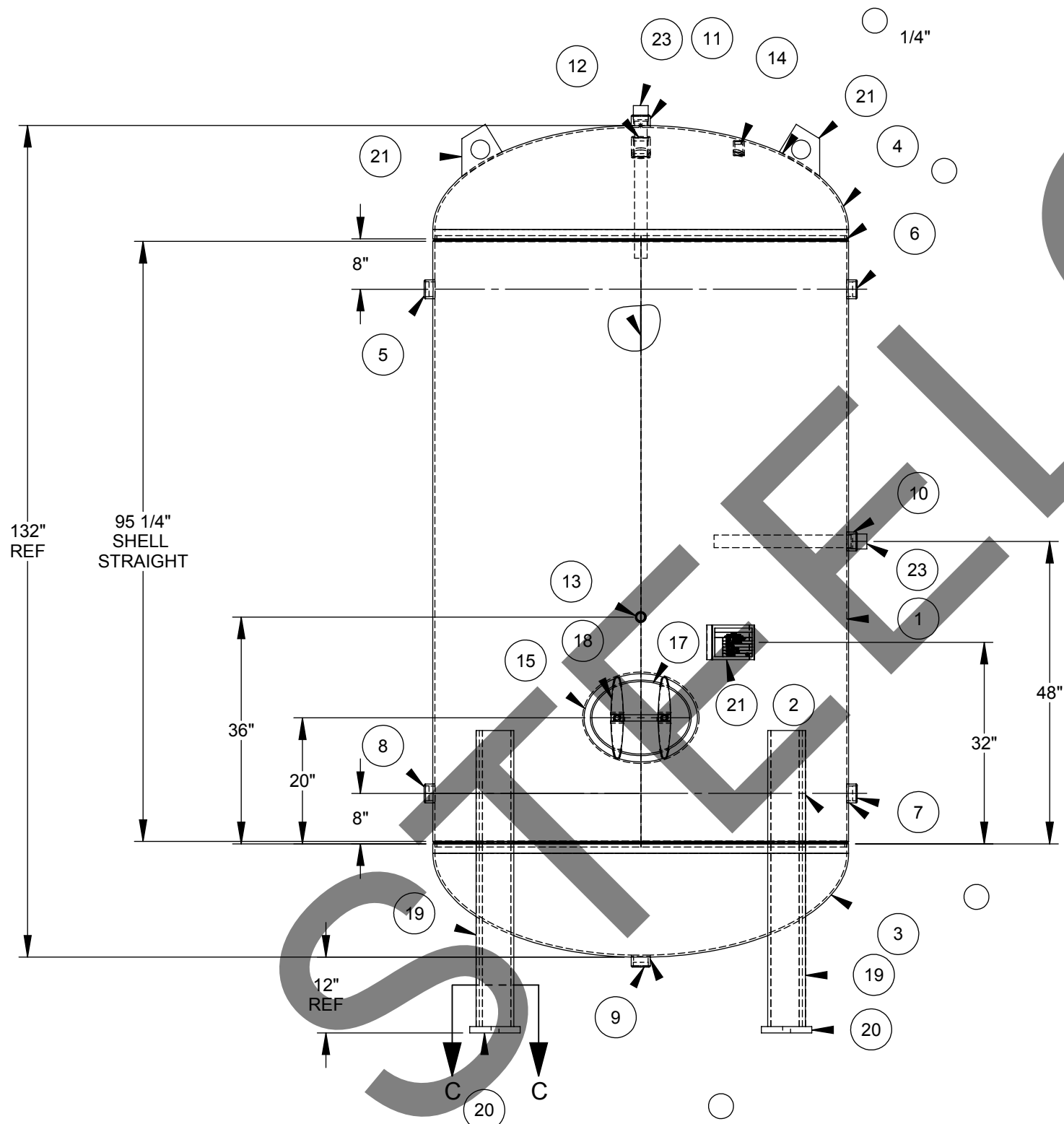

Finish
 Interior:
 Line with Cement to CSA, NSF/ANSI 61 Standard
 Exterior:
 -Primer

Construction Notes

- Bolt holes to straddle centerlines.
- This vessel is designed with superimposed static, dynamic or cyclical reactions due to equipment or mechanical loading, or pressure or thermal variations = 0 lbs.
- This vessel is designed with thermal, mechanical, cyclical, pressure or fluid shock loadings = 0 lbs.
- Round or chamfer all sharp interior corners.
- This vessel is designed to contain a non-lethal gas, vapour or a non-lethal liquid.

<p>TOLERANCES UNLESS OTHERWISE NOTED</p> <p>MACHINING .X = ±.1" .XX = ±.02" .XXX = ±.005" ANGLES ±.5°</p>		<p>WELD FABRICATION <=24" = ±1/16" >24" = ±1/8" ANGLES = ± 0.5°</p>		<p>STEELCRAFT Engineered Products Division</p> <p>487 Lorne Avenue East, PO Box 339, Stratford, Ontario N5A 6T1 P. 1.800.387.6537 F. 519.271.1092 www.steelcraftinc.com</p>	
<p>MAX. MACHINED SURFACE ROUGHNESS 125 MICROINCHES</p>		<p>3RD ANGLE PROJECTION</p>			
<p>THIS PRINT AND DESIGN ARE THE PROPERTY OF STEELCRAFT INC. AND MUST NOT BE USED TO ITS DETRIMENT.</p>					
<p>PRODUCT: 66" O.D. X 132" HIGH STD PV</p>					
<p>DESCRIPTION: MAIN ASSEMBLY</p>					
<p>COMMENTS: SEE BOM FOR MATERIALS</p>					
<p>DRAWN: PEK</p>	<p>CHK'D: NTS</p>	<p>SCALE: NTS</p>	<p>JOB No.: SCDHWT66X132</p>	<p>DRAWING No.: CL43979</p>	<p>REV. No.: 0</p>
<p>DATE: 19/08/2019</p>	<p>DATE: -</p>	<p>WEIGHT: 3187</p>	<p>1</p>	<p>1</p>	<p>FORM ENG-002 REV.3</p>